

ETHERFACE

The EtherFace was designed to interconnect any MADI or AES50 device to a computer thru its Ethernet ports, allowing the transfer of multichannel audio in both directions.

Besides live recording and virtual sound checks, its CoreAudio drivers for MACOS systems and ASIO drivers for Windows systems, allows you to use your favorite DAW for live plugin insertion, showing very low latency

With its reduced dimensions, EtherFace is portable giving you the flexibility to install it anywhere you need, from a reduced FOH or a home studio to Recording truck.

This remarkable device cannot be measured by its size. With its three AES50 interfaces, it can handle up to 72 channels at 96 kHz in both directions at the same time. The MADI version gives you even more, reaching extraordinary 128, 48 kHz, bi-direction channels.



Audio interface



CoreAudio and ASIO drivers developed by DSPRO can turn your network adapter in a multichannel audio interface of up to 128 channels in 48kHz sample rate (MADI version) or up to 72 channels in 96kHz sample rate (AES50 version).

Live Plugins

The optimized drivers make EtherFace line of products the first one on the market of network audio to allow live plugin insertion with very small latencies that shows no noticeable delays in the plugin return.

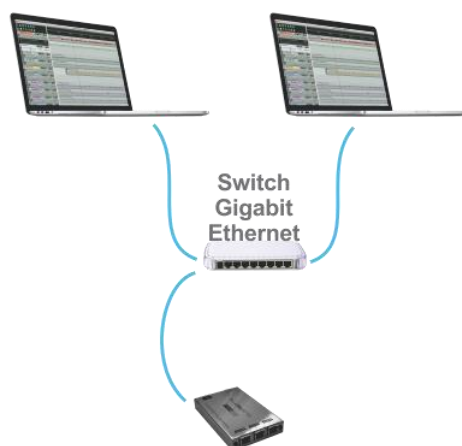
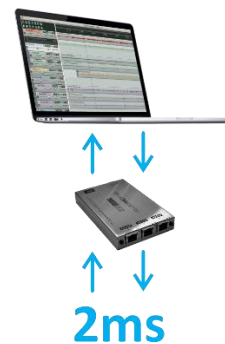

Ethernet Standard

The communication protocol is Ethernet based being compatible with regular IT equipment.

With a standard Ethernet Switch it is possible to duplicate the audio signals for redundant recording in two or more separate computers.

ETHERFACE 3X AES50



This EtherFace version has three AES50 ports for 24 channels at 96 KHz, allowing up to 72 IO channels.

SPECIFICATIONS	
AES50 ports	3
Channels	72 (24 per port)
Sample Rate	48kHz
Power	External DC 12V
PC interface	DSPRO Proprietary Protocol
DAW interface	ASIO or Coreaudio
Latency	2ms (Coreaudio)
Dimensions	135x98x25 mm

ETHERFACE 2X MADI



This EtherFace version has two MADI ports for 64 channels at 48 KHz, allowing up to 128 IO channels.

SPECIFICATIONS	
MADI ports	2
Channels	128 (64 per port)
Sample Rate	48kHz
Power	External DC 12V
PC interface	DSPRO Proprietary Protocol
DAW interface	ASIO or Coreaudio
Latency	2ms (Coreaudio)
Dimensions	134x98x25 mm



CONTACT US

- Support: suporte@dspro.com.br
- Sales: vendas@dspro.com.br
- Phone: +55 51 3044 4469

www.dspro.com.br

DSPRO
Rua São Manoel, 1261 sala 701
CEP 90.620-110 – Porto Alegre –RS
Brazil